

**LEGEND**

CLEAN-OUT	MANHOLE	EXISTING SANITARY SEWER		
HYDRANT	GATE VALVE	EXISTING WATER MAIN		
INLET	RYCB	MANHOLE	CB	EXISTING STORM SEWER
EXISTING BURIED CABLES				
EXISTING GAS MAIN				
UTILITY POLE	GUY POLE	GUY WIRE	EXISTING OVERHEAD LINES	
EXISTING LIGHT POLE	EXISTING SIGN			
<b>PROPOSED</b>				
C.O.	MANHOLE	PR. SANITARY SEWER		
HYDRANT	GATE VALVE	PROPOSED WATER MAIN		
INLET	RYCB	MANHOLE	CB	PROPOSED STORM SEWER
COMPACT TO 95% MAX. DENSITY				
PR. SAND BACKFILL				
UTILITY CROSSING				
PR. TOP OF CURB ELEVATION				
PROPOSED GUTTER ELEVATION				
PR. TOP OF WALK ELEVATION				
PR. TOP OF PAVEMENT ELEV.				
PROPOSED FINISH GRADE				
PROPOSED CONTOUR				
PROPOSED SWALE				
PR. DRAINAGE DIRECTION				
PROPOSED INLET FILTER				
DRAINAGE AREA LIMITS				
PROPOSED SILT FENCE				
LIMITS OF SOIL DISRUPTION				

Sanitary Structure Schedule	
Structure Name	Structure Details
#2 4' DIA SAN. MH EJIW 1040ZPT W/ PONTIAC LOGO	PR. RIM 949.38 PR. 12" E. INV. 939.38 PR. 12" N. INV. 939.48 PR. 8" W. INV. 939.48
#3 4' DIA SAN. MH EJIW 1040ZPT W/ PONTIAC LOGO	PR. RIM 949.38 PR. 12" S. INV. 940.38 PR. 12" N. INV. 940.38
#4 4' DIA SAN. MH EJIW 1040ZPT W/ PONTIAC LOGO	PR. RIM 949.28 PR. 12" S. INV. 941.17 PR. 12" N. INV. 941.17
#E4 TAP & ADJ. EX. SAN. MH	PR. RIM 949.00 PR. 12" S. INV. 941.50 EX. 8" E. INV. 944.01

Profile E4-2

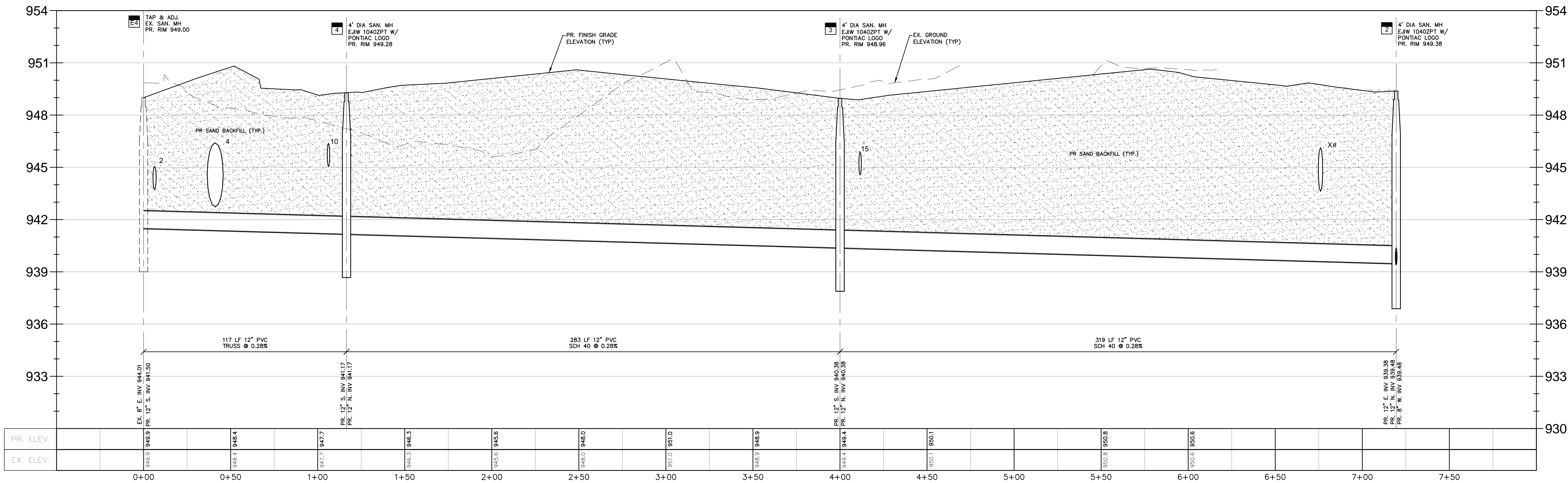

NOWAK & FRAUS ENGINEERS  
46777 WOODWARD AVE.  
PONTIAC, MI 48342-5032  
TEL. (248) 332-7931  
FAX. (248) 332-8257

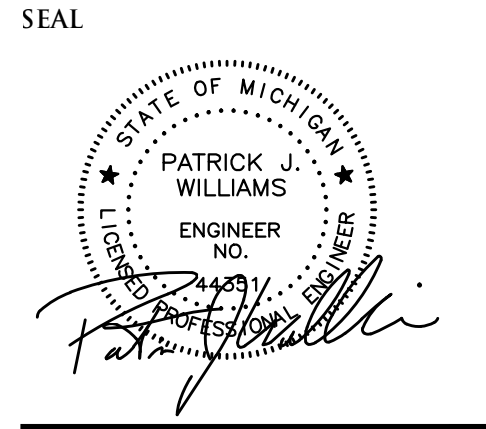

PROJECT  
Village at Bloomfield

CLIENT  
REDICO  
One Towne Square,  
Suite 1600  
Southfield, MI 48076

Contact:  
Phone: (248) 784-6486

PROJECT LOCATION  
Part of the W. 1/2 of Section 5,  
T. 2N., R. 10E., and part of the  
NE 1/4 of Section 6, T. 2N., R.  
10E., Bloomfield Township, The  
City of Pontiac and Bloomfield  
Township (conditionally  
transferred to The City of  
Pontiac) Oakland County,  
Michigan

SHEET  
Sanitary Sewer Plan &  
Profile



DATE ISSUED / REVISED  
05-12-17 Bids / Permits

DRAWN BY:  
A. Wiseman  
DESIGNED BY:  
A. Wiseman  
APPROVED BY:  
P. Williams  
DATE:

03-16-17  
SCALE: 1" = 30' / 1" = 3'

NFE JOB NO. SHEET NO.  
A116-21 C-43